

Kitco, Inc.

Running Boards

505 West Dryden
Odessa, MO 64076
Fax (816) 633-4361

TOLL FREE (800) 455-8606

INSTALLATION PACKAGE

BRACKETS	2
19" TWISTED HANGERS	2
3" ANGLE SUPPROTS	2
BOLT PACK	1
INSTRUCTION SHEET	1

NECESSARY TOOLS

DRILL or SCREW GUN
RATCHET WRENCH w/ 1/2" SOCKET
1/2" COMBINATION WRENCH
SOCKET EXTENSION
SAFETY GLASSES

1. Please thoroughly read all instructions and test fit boards before painting. Mount the running boards as described in previous page of General Instructions.
2. There is one bracket, twisted hanger and 3" angle support provided for each step opening. First bolt the bracket and the 3" angle support together to the topside of the bracket, as shown in Fig A, STEP 1. Position bracket as shown, under the step opening where it is most likely to be stepped on from the topside while accessing the bed of the vehicle. The bracket may sit at a slight angle to the frame to avoid spring shackles or other obstacles.
3. Once this position is found, hold securely in place and attach bracket to the reinforced area on the bottom side of the running board, attach with 14 x 3/4 Hex Head wood screws, 2 per bracket, as shown in Fig A, STEP 2. Do Not Tighten.
4. When these screws are started, secure the topside of bracket by attaching the 3" angle support to the frame side with 14 x 1 Self Drilling Hex Head screws, 2 per bracket, as shown in Fig A, STEP 3. Tighten these screws firmly into place; now tighten wood screws from previous step 1.
5. Finish up by taking the stiffener hanger and attach to the bracket sidewall with 5/16" bolt, lock washer and nut in the hole provided as shown in Fig B, STEP 4, and to the bottom of the bed floor pinch weld with 1 - 14 x 1" Self Drilling Hex Head screw, as shown in Fig B, STEP 5. Tighten all remaining screws and bolts.

BRACKET INSTALLATION INSTRUCTIONS

DODGE, FORD & GM BED BRACKETS

6. Repeat the previous steps on opposite bedside.
7. TEST BRACKETS: Now that all brackets are in their proper place and secured to the vehicle, stand on the running board and test to make sure everything is snug and very secure.

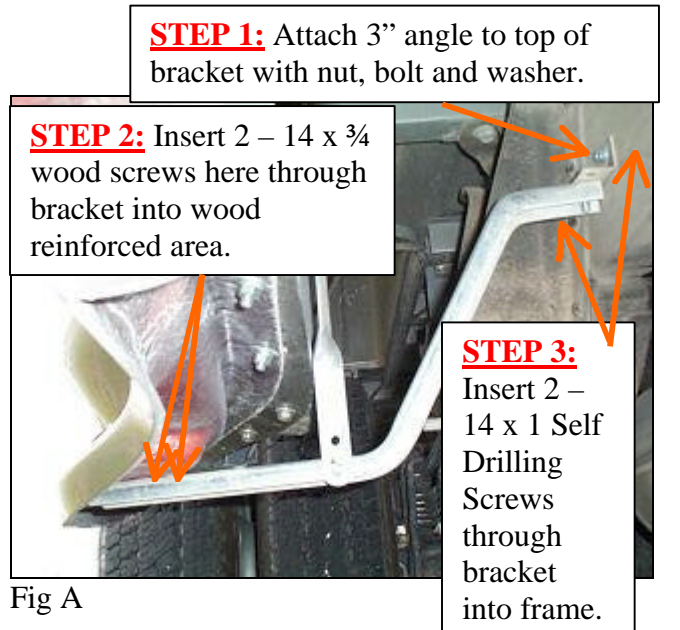

Fig A

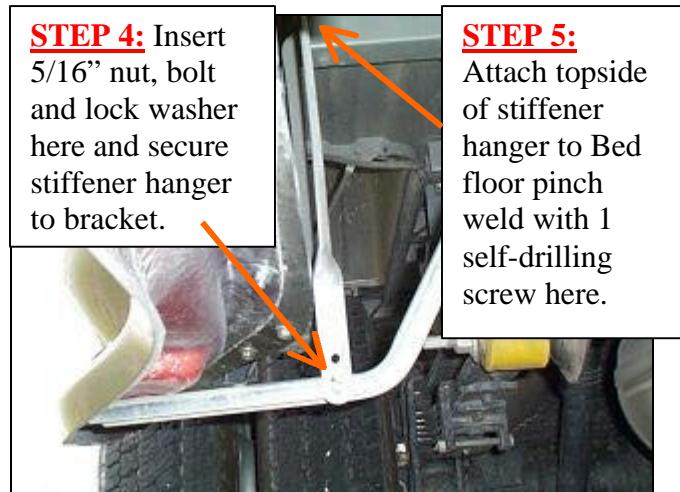

Fig B

**QUESTIONS OR PROBLEMS PLEASE CALL
(800) 455-8606**