

Kitco, Inc.

Running Boards

505 West Dryden
Odessa, MO 64076
Fax (816) 633-4361

TOLL FREE (800) 455-8606

INSTALLATION PACKAGE

BRACKETS	2 - Reg. Cab or 4 - Ex/Crew Cab
STIFFENER HANGERS	2 - Reg. Cab or 4 - Ex/Crew Cab
BOLT PACK	1
INSTRUCTION SHEET	1

NECESSARY TOOLS

DRILL or SCREW GUN
RATCHET WRENCH w/ ½" SOCKET
½" COMBINATION WRENCH
SOCKET EXTENSION
SAFETY GLASSES

1. Please thoroughly read all instructions and test fit boards before painting. Mount the running boards as described in previous page of General Instructions.
2. There is one bracket and stiffener hanger provided for each door opening. Position bracket as shown in Fig A under the door opening where it is most likely to be stepped on from the topside while entering vehicle.
3. Once this position is found, hold securely in place and attach bracket to the reinforced area on the bottom side of the running board, attach with 14 x ¾ Hex Head wood screws, 2 per bracket, as shown in Fig A, STEP 1. Do Not Tighten.
4. Once these screws are started, secure the topside of bracket to the sub floor with 14 x 1 Self Drilling Hex Head screws, 2 per bracket, as shown in Fig A, STEP 2. Tighten these screws firmly into place; now tighten wood screws from previous step 1.
5. Finish up by take the stiffener hanger and attach to the bracket sidewall with 5/16" bolt, lock washer and nut in the hole provided as shown in Fig B, STEP 3, and to the backside of the rocker panel with 2 - 14 x 1" Self Drilling Hex Head screws, as shown in Fig B, STEP 4. Tighten all remaining screws and bolts.
6. Repeat the previous steps on remaining door openings, until all brackets and stiffener hangers are securely attached to running boards and the vehicle under body.
7. TEST BRACKETS: Now that all brackets are in there proper place and secured to the vehicle, stand on the running board and test to make sure everything is snug and very secure.

BRACKET INSTALLATION INSTRUCTIONS

99-CURRENT FORD SUPER DUTY CAB BRACKETS

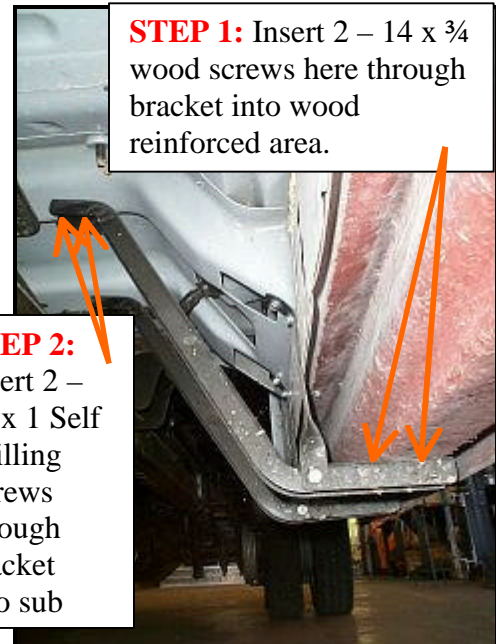

Fig A

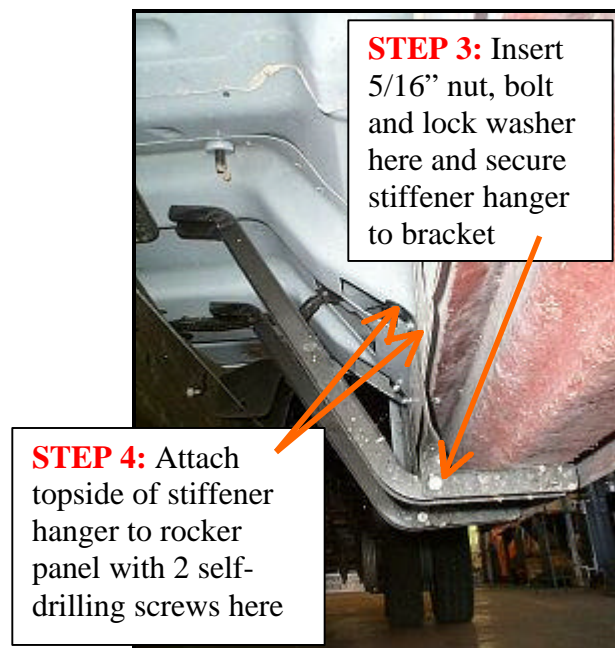

Fig B

**QUESTIONS OR PROBLEMS PLEASE CALL
(800) 455-8606**